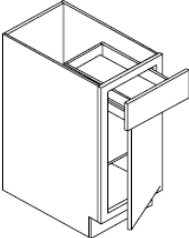

PREMIUM SOLID WOOD CABINETRY

CABINET SPECIFICATION DIMENSION AVAILABILITY

BASE CABINET - 1 DRAWER, 1 DOOR, 1 SHELF

	Item Code	W" X D" X H"	B2	H6	D3	K10	M01	A7	K8	J5
	B09	09 X 24 X 34.5	●	●	●	●	●	●	●	●
	B12	12 X 24 X 34.5	●	●	●	●	●	●	●	●
	B15	15 X 24 X 34.5	●	●	●	●	●	●	●	●
	B18	18 X 24 X 34.5	●	●	●	●	●	●	●	●
	B21	21 X 24 X 34.5	●	●	●	●	●	●	●	●

BASE CABINET - 1 DRAWER, 2 DOOR, 1 SHELF

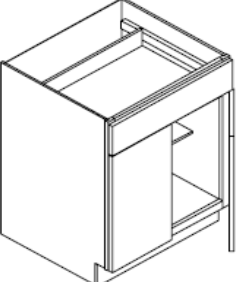
	Item Code	W" X D" X H"	B2	H6	D3	K10	M01	A7	K8	J5
	B24	24 X 24 X 34.5	●	●	●	●	●	●	●	●
	B27	27 X 24 X 34.5	●	●	●	●	●	●	●	●

BASE CABINET - 2 DRAWER, 2 DOOR, 1 SHELF

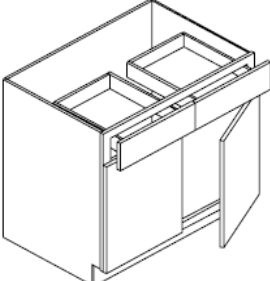
	Item Code	W" X D" X H"	B2	H6	D3	K10	M01	A7	K8	J5
	B30	30 X 24 X 34.5	●	●	●	●	●	●	●	●
	B33	33 X 24 X 34.5	●	●	●	●	●	●	●	●
	B36	36 X 24 X 34.5	●	●	●	●	●	●	●	●
	B42	42 X 24 X 34.5	●	●	●	●	●	●	●	●

BASE DRAWER CABINET - 3 DRAWERS

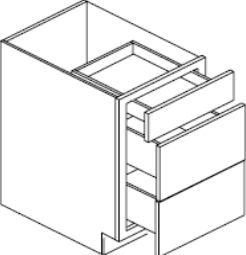
	Item Code	W" X D" X H"	B2	H6	D3	K10	M01	A7	K8	J5
	DB15-3	15 X 24 X 34.5	●	●	●	●	●	●	●	●
	DB18-3	18 X 24 X 34.5	●	●	●	●	●	●	●	●
	DB21-3	21 X 24 X 34.5	●	●	●	●	●	●	●	●
	DB24-3	24 X 24 X 34.5	●	●	●	●	●	●	●	●
	DB30-3	30 X 24 X 34.5	●	●	●	●	●	●	●	●
	DB36-3	36 X 24 X 34.5	●	●	●	●	●	●	●	●

SINK BASE CABINET - 2 DUMMY DRAWER, 2 DOORS

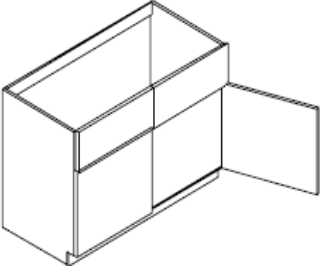
	Item Code	W" X D" X H"	B2	H6	D3	K10	M01	A7	K8	J5
	SB30	30 X 24 X 34.5	●	●	●	●	●	●	●	●
	SB33	33 X 24 X 34.5	●	●	●	●	●	●	●	●
	SB36	36 X 24 X 34.5	●	●	●	●	●	●	●	●
	SB42	42 X 24 X 34.5	●	●	●	●	●	●	●	●

BASE WASTE BASKET - 1 DRAWER, 1 DOOR

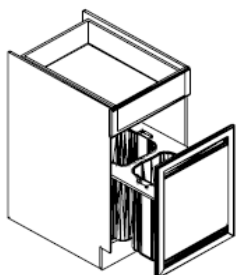
	Item Code	W" X D" X H"	B2	H6	D3	K10	M01	A7	K8	J5
	BWBK18-2	18 X 24 X 34.5	•	•	•	•	•	•	•	•
	<p>Note: K10, M01, K8, J5, AND A7 has 1 Pre-cut hole, does not come with basket :::: B2, H6, D3 has 2 Pre-cut Hole</p>									

LAZY SUSAN CABINET- LAZY SUSAN, FOLDING DOORS (Includes Wood Lazy Susan)

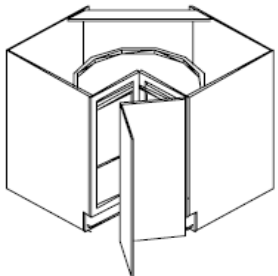
	Item Code	W" X D" X H"	B2	H6	D3	K10	M01	A7	K8	J5
	LS3612	36 X 24 X 34.5	•	•	•	•	•	•	•	•

CORNER LAZY SUSAN CABINET- 1 DOOR

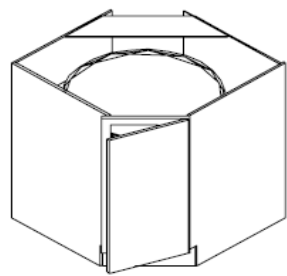
	Item Code	W" X D" X H"	B2	H6	D3	K10	M01	A7	K8	J5
	CBD36	36 X 24 X 34.5	•	•	•	•	•	•	•	•
	<p>Note: This can also be used as CSB36, just leave out the Lazy Susan</p>									

CORNER SINK CABINET- 1 DOOR, 1 SHELF

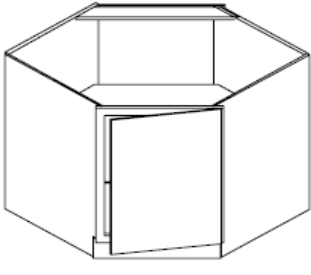
	Item Code	W" X D" X H"	B2	H6	D3	K10	M01	A7	K8	J5
	CSB36	36 X 24 X 34.5	•	•	•	•	•	•	•	•

BLIND CORNER CABINET- 1 DRAWER, 1 DOOR, 1 SHELF

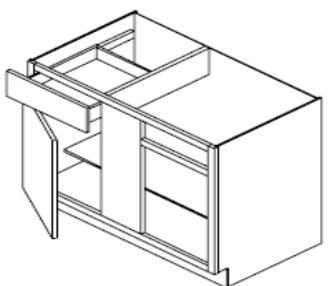
	Item Code	W" X D" X H"	B2	H6	D3	K10	M01	A7	K8	J5
	BBC42	42 X 24 X 34.5	•	•	•	•	•	•	•	•
	<p>**** PULL 3" FROM WALL. 45" CLEARANCE NEEDED- RECOMMENDED **** LEFT / RIGHT [Picture shown BBC42R, opening on right]</p>									

SPICE PULL OUT - 1 FULL HEIGHT DOOR

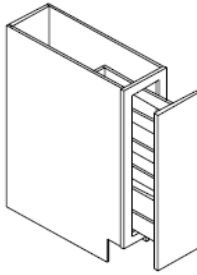
	Item Code	W" X D" X H"	B2	H6	D3	K10	M01	A7	K8	J5
	SP09	09 X 24 X 34.5	•	•	•	•	•	•	•	•

SPICE DRAWER- 5 SPICE DRAWER

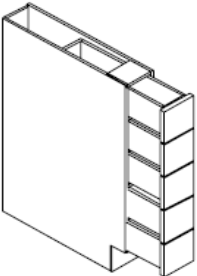
	Item Code	W" X D" X H"	B2	H6	D3	K10	M01	A7	K8	J5
	BWRC6	06 X 24 X 34.5	•	•	•	•	•	•	•	•

BASE END CORNER CABINET - 2 DOOR 1 SHELF 2 DUMMY DOOR

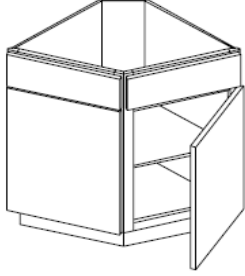
	Item Code	W" X D" X H"	B2	H6	D3	K10	M01	A7	K8	J5
	BEC24	24 X 24 X 34.5	•	•	•	•	•	•	•	•

Note: Dummy drawer panel on top.

BASE END SHELF - 3 SHELVES

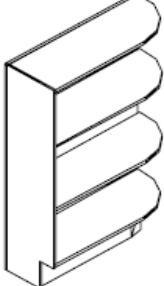
	Item Code	W" X D" X H"	B2	H6	D3	K10	M01	A7	K8	J5
	BES09	09 X 24 X 34.5	•	•	•	•	•	•	•	•

Note: Use this for Right / Left

PENINSULA BASE CABINET- 2 DOOR 2 DRAWER

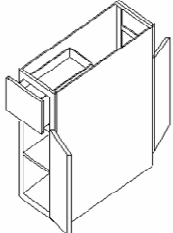
	Item Code	W" X D" X H"				K10	M01	A7	K8	J5
	PB18	18 X 33 X 34.5				•	•	na	na	na

Note: Can be open from both side.

PENINSULA BASE CABINET- 4 DOOR 2 DRAWER

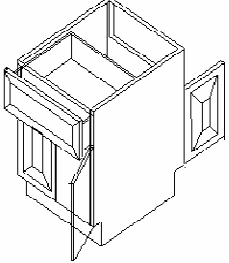
	Item Code	W" X D" X H"				K10	M01	A7	K8	J5
	PB24	24 X 33 X 34.5				•	•	na	na	na
	Note: Can be open from both side.									

PENINSULA BASE CABINET- 4 DOOR 4 DRAWER

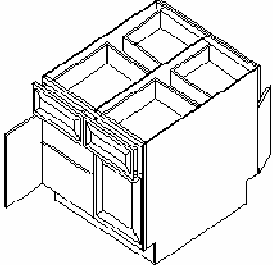
	Item Code	W" X D" X H"				K10	M01	A7	K8	J5
	PB30	30 X 33 X 34.5				•	•	na	na	na
	PB36	36 X 33 X 34.5				•	•	na	na	na
Note: Can be open from both side.										

KNEE DRAWER- 1 DRAWER

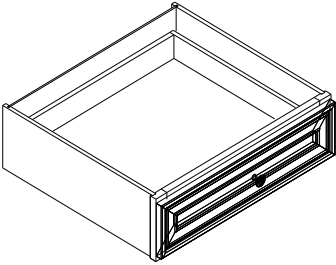
	Item Code	W" X D" X H"				K10	M01	A7	K8	J5
	FD30	30 X 21 X 06				•	•	•	•	
	FD30	30 x 21 X 8.5								•

WALL CABINET- 1 DOOR 2 SHELF

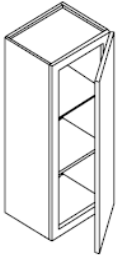
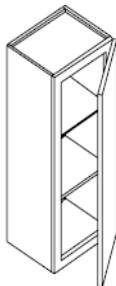
	Item Code	W" X D" X H"	B2	H6	D3	K10	M01	A7	K8	J5
	W0930	09 X 12 X 30	•	•	•	•	•	•	•	•
	W1230	12 X 12 X 30	•	•	•	•	•	•	•	•
	W1530	15 X 12 X 30	•	•	•	•	•	•	•	•
	W1830	18 X 12 X 30	•	•	•	•	•	•	•	•
	W2130	21 X 12 X 30	•	•	•	•	•	•	•	•
	W0936	09 X 12 X 36	•	•	•	•	•	•	•	•
	W1236	12 X 12 X 36	•	•	•	•	•	•	•	•
	W1536	15 X 12 X 36	•	•	•	•	•	•	•	•
	W1836	18 X 12 X 36	•	•	•	•	•	•	•	•
	W2136	21 X 12 X 36	•	•	•	•	•	•	•	•

WALL CABINET- 2 DOOR 2 SHELF

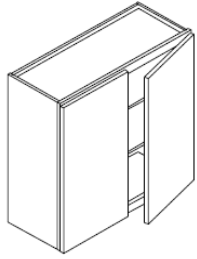

Item Code	W" X D" X H"	B2	H6	D3	K10	M01	A7	K8	J5
W2430	24 X 12 X 30	•	•	•	•	•	•	•	•
W2730	27 X 12 X 30	•	•	•	•	•	•	•	•
W3030	30 X 12 X 30	•	•	•	•	•	•	•	•
W3330	33 X 12 X 30	•	•	•	•	•	•	•	•
W3630	36 X 12 X 30	•	•	•	•	•	•	•	•

WALL CABINET- 2 DOOR 2 SHELF

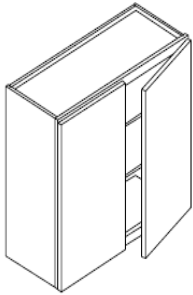

Item Code	W" X D" X H"	B2	H6	D3	K10	M01	A7	K8	J5
W2436	24 X 12 X 36	•	•	•	•	•	•	•	•
W2736	27 X 12 X 36	•	•	•	•	•	•	•	•
W3036	30 X 12 X 36	•	•	•	•	•	•	•	•
W3336	33 X 12 X 36	•	•	•	•	•	•	•	•
W3636	36 X 12 X 36	•	•	•	•	•	•	•	•

WALL CABINET- 1 DOOR 3 SHELF

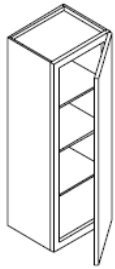

Item Code	W" X D" X H"	B2	H6	D3	K10	M01	A7	K8	J5
W0942	09 X 12 X 42	•	•	•	•	•	•	•	•
W1242	12 X 12 X 42	•	•	•	•	•	•	•	•
W1542	15 X 12 X 42	•	•	•	•	•	•	•	•
W1842	18 X 12 X 42	•	•	•	•	•	•	•	•
W2142	21 X 12 X 42	•	•	•	•	•	•	•	•

WALL CABINET- 2 DOOR 3 SHELF

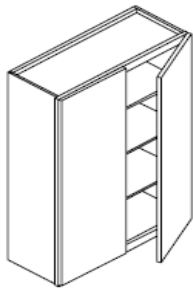

Item Code	W" X D" X H"	B2	H6	D3	K10	M01	A7	K8	J5
W2442	24 X 12 X 42	•	•	•	•	•	•	•	•
W2742	27 X 12 X 42	•	•	•	•	•	•	•	•
W3042	30 X 12 X 42	•	•	•	•	•	•	•	•
W3342	33 X 12 X 42	•	•	•	•	•	•	•	•
W3642	36 X 12 X 42	•	•	•	•	•	•	•	•

WALL GLASS CABINET- 1 GLASS DOOR FRAME ::: w/ Matching Interior

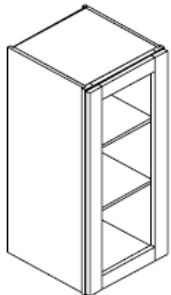

Item Code	W" X D" X H"	B2	H6	D3	K10	M01	A7	K8	J5
WM153615H	15 x 15 x 36	•	•	•	•	•	NA	NA	NA
WM1530H	15 x 12 x 30	•	•	NA	•	•	•	•	•
WM1830H	18 x 12 x 30	•	•	•	•	•	•	•	•
WM1536H	15 x 12 x 36	•	•	NA	•	•	•	•	•
WM1836H	18 x 12 x 36	•	•	•	•	•	•	•	•

***Glass inserts & Glass Shelves sold separately**

WALL GLASS CABINET- 2 GLASS DOOR FRAME::: w/ Matching Interior

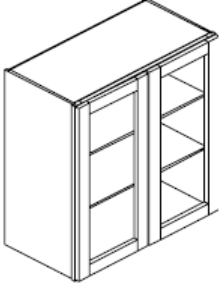
	Item Code	W" X D" X H"	B2	H6	D3	K10	M01	A7	K8	J5
	WM2430H	24 x 12 x 30	•	•	•	•	•	•	•	•
	WM2730H	27 x 12 x 30	•	•	•	•	•	•	•	•
	WM3030H	30 x 12 x 30	•	•	•	•	•	•	•	•
	WM2436H	24 x 12 x 36	•	•	•	•	•	•	•	•
	WM2736H	27 x 12 x 36	•	•	•	•	•	•	•	•
	WM3036H	30 x 12 x 36	•	•	•	•	•	•	•	•

***Glass inserts & Glass Shelves sold separately**

WALL GLASS CABINET- 2 GLASS DOOR FRAME::: w/ Matching Interior

	Item Code	W" X D" X H"	B2	H6	D3	K10	M01	A7	K8	J5
	WM154215H	15 x 15 x 42	•	•	•	•	•	NANA	NA	NA
	WM1542H	15 x 12 x 42	•	•	NA	•	•	•	•	•
	WM1842H	18 x 12 x 42	•	•	•	•	•	•	•	•

***Glass inserts & Glass Shelves sold separately**

WALL GLASS CABINET- 2 GLASS DOOR FRAME ::: w/ Matching Interior

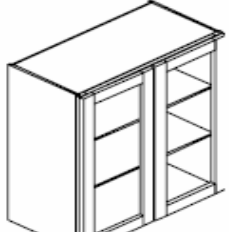
	Item Code	W" X D" X H"	B2	H6	D3	K10	M01	A7	K8	J5
	WM2442H	24 x 12 x 42	•	•	•	•	•	•	•	•
	WM2742H	27 x 12 x 42	•	•	•	•	•	•	•	•
	WM3042H	30 x 12 x 42	•	•	•	•	•	•	•	•

***Glass inserts & Glass Shelves sold separately**

WALL GLASS CABINET- 1 GLASS DOOR FRAME ::: w/ Matching Interior

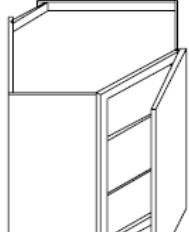
	Item Code	W" X D" X H"	B2	H6	D3	K10	M01	A7	K8	J5
	WMDC2430H	24 x 24 x 30	•	•	•	•	•	•	•	•
	WMDC2436H	24 x 24 x 36	•	•	•	•	•	•	•	•
	WMDC273615H	27 x 27 x 36	•	•	•	•	•	•	•	•

***Glass inserts & Glass Shelves sold separately**

WALL GLASS CABINET- 1 GLASS DOOR FRAME ::: w/ Matching Interior

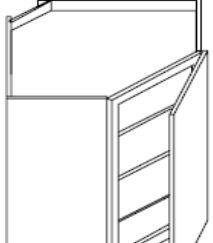
	Item Code	W" X D" X H"	B2	H6	D3	K10	M01	A7	K8	J5
	WMDC2442H	24 x 24 x 42	•	•	•	•	•	•	•	•
	WMDC274215H	27 x 27 x 42	•	•	•	•	•	•	•	•

***Glass inserts & Glass Shelves sold separately**

GLASS INSERT FOR WM####H

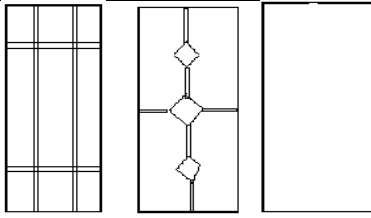

-01 -03 PLAIN

Item Code	W" X D" X H"	B2	H6	D3	K10	M01	A7	K8	J5
-01		•	•	•	•	•	•	•	•
-03									
-PLAIN									

GLASS SHELF FOR WM####H



Item Code	W" X D" X H"	B2	H6	D3	K10	M01	A7	K8	J5
WM153615/4215H		•	•	•	•	•	•	•	•
WM1530/36/42H		•	•	•	•	•	•	•	•
WM1830/36/42H		•	•	•	•	•	•	•	•
WM2430/36/42H		•	•	•	•	•	•	•	•
WM2730/36/42H		•	•	•	•	•	•	•	•
WM3030/36/42H		•	•	•	•	•	•	•	•
WMDC2430/36/42H		•	•	•	•	•	•	•	•
WMDC273615/4215H		•	•	•	•	•	•	•	•

WALL CABINET BRIDGE- 2 DOOR

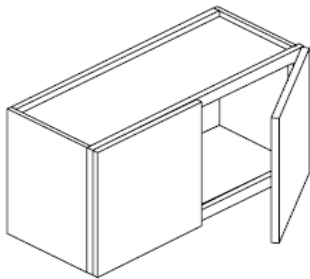

Item Code	W" X D" X H"	B2	H6	D3	K10	M01	A7	K8	J5
W3012	30 X 12 X 12	•	•	•	•	•	•	•	•
W3015	30 X 12 X 15	•	•	•	•	•	•	•	•
W3018	30 X 12 X 18	•	•	•	•	•	•	•	•
W3612	36 X 12 X 12	•	•	•	•	•	•	•	•
W3615	36 X 12 X 15	•	•	•	•	•	•	•	•
W3618	36 X 12 X 18	•	•	•	•	•	•	•	•

WALL CABINET BRIDGE- 2 DOOR

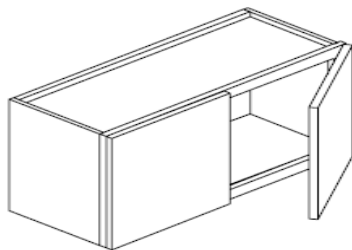

Item Code	W" X D" X H"	B2	H6	D3	K10	M01	A7	K8	J5
W361227	36 X 27 X 12	•	•	•	•	•	•	•	•
W361527	36 X 27 X 15	•	•	•	•	•	•	•	•
W361827	36 X 27 X 18	•	•	•	•	•	•	•	•

WALL CABINET BRIDGE- 2 DOOR, 1 SHELF

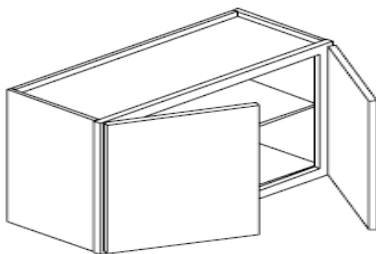

Item Code	W" X D" X H"	B2	H6	D3	K10	M01	A7	K8	J5
W3024	30 X 12 X 24	•	•	•	•	•	•	•	•
W3624	36 X 12 X 24	•	•	•	•	•	•	•	•
W362427	36 X 27 X 24	•	•	•	•	•	•	•	•

WALL DIAGONAL CABINET- 1 DOOR, 2 SHELF

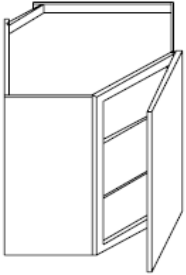
	Item Code	W" X D" X H"	B2	H6	D3	K10	M01	A7	K8	J5
	WDC2430	24 x 24 x 30	●	●	●	●	●	●	●	●
	WDC2436	24 x 24 x 36	●	●	●	●	●	●	●	●
	WDC273615	27 x 27 x 36	●	●	●	●	●	●	●	●

WALL DIAGONAL CABINET- 1 DOOR, 3 SHELF

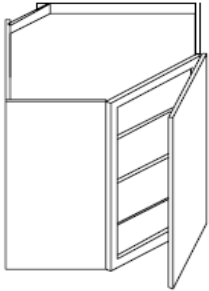
	Item Code	W" X D" X H"	B2	H6	D3	K10	M01	A7	K8	J5
	WDC2442	24 x 24 x 42	●	●	●	●	●	●	●	●
	WDC274215	27 x 27 x 42	●	●	●	●	●	●	●	●

WALL END CABINER- 2 DOORS, 2 SHELF ON 30" & 36"H, 3 SHELF ON 42"H

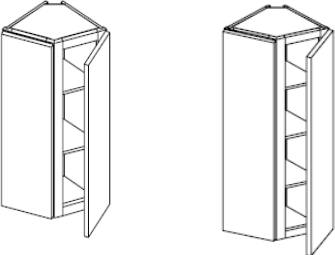
	Item Code	W" X D" X H"	B2	H6	D3	K10	M01	A7	K8	J5
	WEC1230	12 x 12 x 30	●	●	●	●	●	●	●	●
	WEC1236	12 x 12 x 36	●	●	●	●	●	●	●	●
	WEC1242	12 x 12 x 42	●	●	●	●	●	●	●	●

WEC1230/36 WEC1242

WALL END SHELF- 2 SHELF ON 30" & 36"H, 3 SHELF ON 42"H

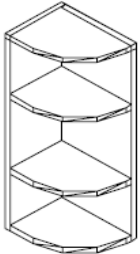
	Item Code	W" X D" X H"	B2	H6	D3	K10	M01	A7	K8	J5
	WES0930	09 x 12 x 30	●	●	●	●	●	●	●	●
	WES0936	09 x 12 x 36	●	●	●	●	●	●	●	●
	WES0942	09 x 12 x 42	●	●	●	●	●	●	●	●

WALL WINE RACK

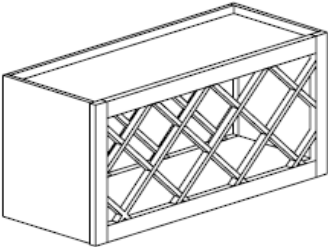
	Item Code	W" X D" X H"	B2	H6	D3	K10	M01	A7	K8	J5
	30WR	30 x 12 x 15	●	●	●	●	●	●	●	●
	36WR	36 x 12 x 15	●	●	●	●	●	●	●	●

WALL GLASS RACK

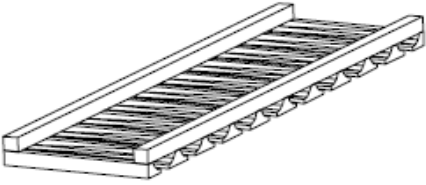
	Item Code	W" X D" X H"	B2	H6	D3	K10	M01	A7	K8	J5
	30GR	30 x 12 x 3	•	•	•	•	•	•	•	•
	36GR	36 x 12 x 3	•	•	•	•	•	•	•	•

WALL MICROWAVE CABINET

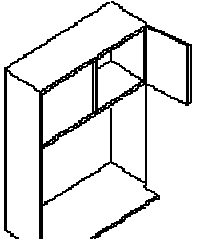
	Item Code	W" X D" X H"	B2	H6	D3	K10	M01	A7	K8	J5
	WBL2730	27 x 12 x 30	•	•	•	•	•	•	•	•
	WBL2736	27 x 12 x 36	•	•	•	•	•	•	•	•
	WBL2742	27 x 12 x 42	•	•	•	•	•	•	•	•

***NOTE: FOR B2/H6/D3 MICROWAVE PANEL SOLD SEPERATELY code: GB**

APPLIANCE GARAGE

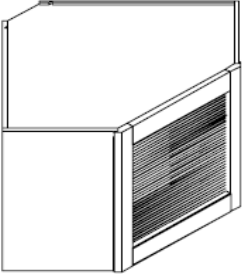
	Item Code	W" X D" X H"	B2	H6	D3	K10	M01	A7	K8	J5
	AG2418	24 x 24 x 18	•	•	•	•	•	•	•	•
	AG2718	27 x 27 x 18	•	•	•	•	•	•	•	•

WALL SPICE DRAWER

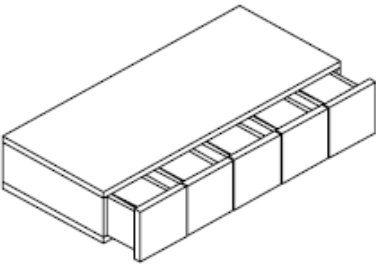
	Item Code	W" X D" X H"	B2	H6	D3	K10	M01	A7	K8	J5
	WWRC-6	30 x 12 x 06	•	•	•	•	•	•	•	•

TALL PANTRY - FOR K10, M01, J5, K8, A7

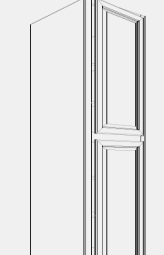
	Item Code	W" X D" X H"	B2	H6	D3	K10	M01	A7	K8	J5
	WP188427	18 x 27 x 84				•	•	•	•	•
	WP189027	18 x 27 x 90				•	•	•	•	•
	WP189627	18 x 27 x 96				•	•	•	•	•

*** 3 ROLL OUT TRAY ON THE BOTTOM, SHELVES ON TOP**

TALL PANTRY - FOR K10, M01 ONLY

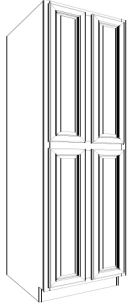

Item Code	W" X D" X H"				K10	M01	A7	K8	J5
WP248427	24 x 27 x 84				•	•	•	•	•
WP249027	24 x 27 x 90				•	•	•	•	•
WP249627	24 x 27 x 96				•	•	•	•	•
WP308427	30 x 27 x 84				•	•	•	•	•
WP309027	30 x 27 x 90				•	•	•	•	•
WP309627	30 x 27 x 96				•	•	•	•	•

*** 3 ROLL OUT TRAY ON THE BOTTOM, SHELVES ON TOP**

TALL PANTRY - FOR B2, D3, H6,

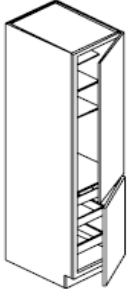

Item Code	W" X D" X H"	B2	H6	D3					
WP188427	18 x 27 x 84	•	•	•					
WP189027	18 x 27 x 90	•	•	•					
WP189627	18 x 27 x 96	•	•	•					

*** 3 ROLL OUT TRAY ON THE BOTTOM, SHELVES ON TOP**

TALL PANTRY - FOR B2, D3, H6, H9



Item Code	W" X D" X H"	B2	H6	D3					
WP248427	24 x 27 x 84	•	•	•					
WP249027	24 x 27 x 90	•	•	•					
WP249627	24 x 27 x 96	•	•	•					
WP308427	30 x 27 x 84	•	•	•					
WP309027	30 x 27 x 90	•	•	•					
WP309627	30 x 27 x 96	•	•	•					

*** 3 ROLL OUT TRAY ON THE BOTTOM, SHELVES ON TOP**

SINGLE OVEN CABINET :: 2 Drawers, 2 Doors

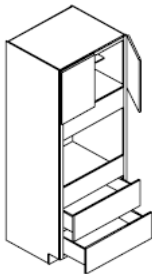

Item Code	W" X D" X H"	B2	H6	D3	K10	M01	A7	K8	J5
OC309027	30 x 27 x 90	•	•	•	•	•	•	•	•
OC309627	30 x 27 x 96	•	•	•	•	•	•	•	•
OC339027	33 x 27 x 90	•	•	•	NA	NA	NA	NA	NA
OC339627	33 x 27 x 96	•	•	•	NA	NA	NA	NA	NA

******* OPENING WIDTH 27" on 30" Oven :: 30" on 33" Oven ::: Max Height 44" on B2/H6/D3 ::: Max Height 50" on K10/M01/A7/K8/J5/E9**

DOUBLE OVEN CABINET

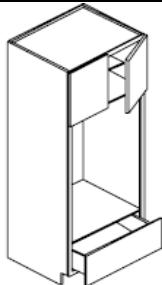

Item Code	W" X D" X H"	B2	H6	D3	K10	M01	A7	K8	J5
OC309027WO	30 x 27 x 90	•	•	•	•	•	•	•	•
OC309627WO	30 x 27 x 96	•	•	•	•	•	•	•	•
OC339027WO	33 x 27 x 90	•	•	•	NA	NA	NA	NA	NA
OC339627WO	33 x 27 x 96	•	•	•	NA	NA	NA	NA	NA

******* OPENING WIDTH 27" on 30" Oven :: 30" on 33" Oven ::: Max Height 59" on B2/H6/D3 ::: Max Height 59 1/2" on K10/M01/A7/K8/J5/E9**

BASE DUMMY DOOR

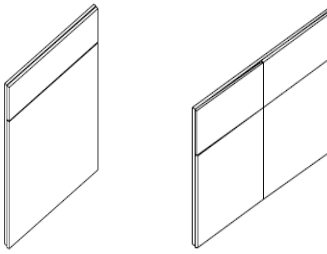
	Item Code	W" X D" X H"	B2	H6	D3	K10	M01	A7	K8	J5
	B18F	18 x 1.5 x 30	•	•	•	•	•	•	•	•
	B30F	30 x 1.5 x 30	•	•	•	•	•	•	•	•
	B36F	36 x 1.5 x 30	•	•	•	•	•	•	•	•
B18F	B30F/B36F									

BASE END DUMMY DOOR

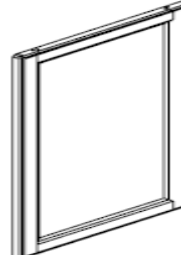
	Item Code	W" X D" X H"	B2	H6	D3	K10	M01	A7	K8	J5
	BDD24	24 x 3/4 x 30	•	•	•	•	•	•	•	•

WALL END DUMMY DOOR

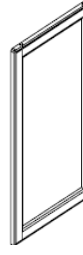
	Item Code	W" X D" X H"	B2	H6	D3	K10	M01	A7	K8	J5
	W1230F	12 x 3/4 x 30	•	•	•	•	•	•	•	•
	W1236F	12 x 3/4 x 36	•	•	•	•	•	•	•	•
	W1242F	12 x 3/4 x 42	•	•	•	•	•	•	•	•

LARGE DENTIL MOLDING

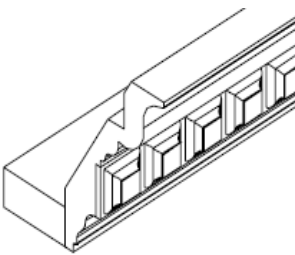
	Item Code	L x H	B2	H6	D3	K10	M01	A7	K8	J5
	CCM8-A	96 x 4	•	•	•	NA	NA	NA	NA	NA
	CCM10-A	120 x 4	NA	NA	NA	•	•	•	•	•

DENTIL MOLDING

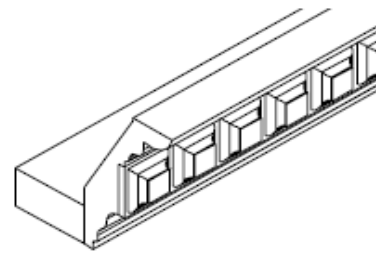
	Item Code	L x H	B2	H6	D3	K10	M01	A7	K8	J5
	CCM8-B	96 x 3	•	•	•	NA	NA	NA	NA	NA
	CCM10-B	120 x 3	NA	NA	NA	•	•	•	•	•

LARGE CROWN MOLDING

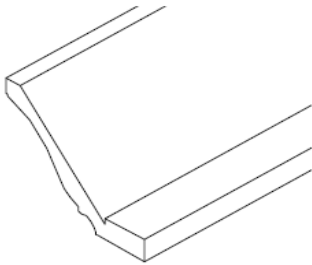
	Item Code	L x H	B2	H6	D3	K10	M01	A7	K8	J5
	ACM8 5 1/4	96 x 4	•	•	•	NA	NA	NA	NA	NA
	ACM10 5 1/4	120 x 4	NA	NA	NA	•	•	•	•	•

LARGE CROWN MOLDING

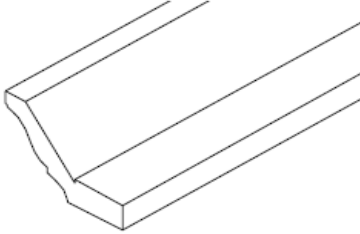
	Item Code	L x H	B2	H6	D3	K10	M01	A7	K8	J5
	ACM8 3 1/4	96 x 2 1/4	•	•	•	NA	NA	NA	NA	NA
	ACM10 3 1/4	120 x 2 1/4	NA	NA	NA	•	•	•	•	•

CROWN MOLDING

	Item Code	L x H	B2	H6	D3	K10	M01	A7	K8	J5
	CM8	96 x 2	•	•	•	NA	NA	NA	NA	NA
	CM10	120 x 2	NA	NA	NA	•	•	•	•	•

WIDE DENTIL MOLDING

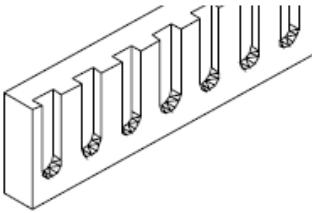
	Item Code	L x H	B2	H6	D3	K10	M01	A7	K8	J5
	WDM8	96 x 2	•	•	•	NA	NA	NA	NA	NA
	WDM10	120 x 2	NA	NA	NA	•	•	•	•	•

LIGHT RAIL MOLDING

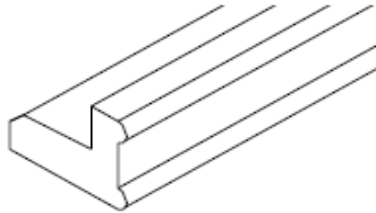
	Item Code	L x H	B2	H6	D3	K10	M01	A7	K8	J5
	TLR8-A	96 x 1 1/2	•	•	•	NA	NA	NA	NA	NA
	TLR10-A	120 x 1 1/2	NA	NA	NA	•	•	•	•	•

TOE KICK/ TOE PLATE

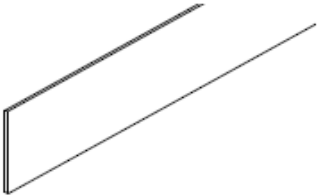
	Item Code	L x H	B2	H6	D3	K10	M01	A7	K8	J5
	TK8	96 x 4.5	•	•	•	•	•	•	•	•

BASE MOLDING

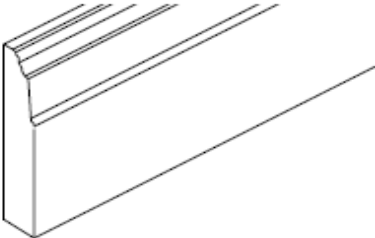
	Item Code	L x H	B2	H6	D3	K10	M01	A7	K8	J5
	BM8	96 x 4	•	•	•	NA	NA	NA	NA	NA
	BM10	120 x 4	NA	NA	NA	•	•	•	•	•

OUTSIDE CORNER MOLDING

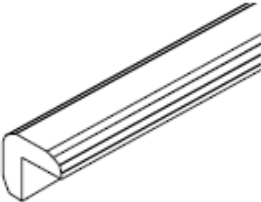
	Item Code	L x H	B2	H6	D3	K10	M01	A7	K8	J5
	OCM8	96 x 1/4	•	•	•	•	•	•	•	•

OGEE MOLDING

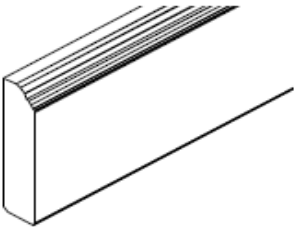
	Item Code	L x H	B2	H6	D3	K10	M01	A7	K8	J5
	OGM8	96 x 3/4	•	•	•	NA	NA	NA	NA	NA
	OGM10	120 x 3/4	NA	NA	NA	•	•	•	•	•

QUARTER ROUND MOLDING

	Item Code	L x H	B2	H6	D3	K10	M01	A7	K8	J5
	QRM8	96 x 1/4	•	•	•	NA	NA	NA	NA	NA
	QRM10	120 x 1/4	NA	NA	NA	•	•	•	•	•

SCRIBE MOLDING / TRIM MOLDING

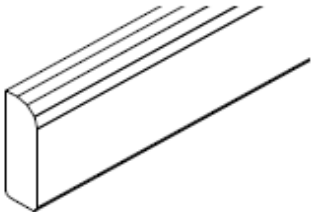
	Item Code	L x H	B2	H6	D3	K10	M01	A7	K8	J5
	SM8	96 x 1/4	•	•	•	•	•	•	•	•

CHAIR RAIL MOLDING

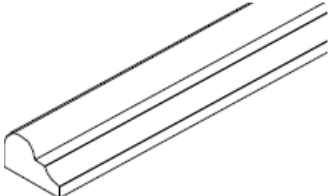
	Item Code	L x H	B2	H6	D3	K10	M01	A7	K8	J5
	CR8	96 x 1	•	•	•	NA	NA	NA	NA	NA
	CR10	120 x 1	NA	NA	NA	•	•	•	•	•

CHAIR RAIL MOLDING

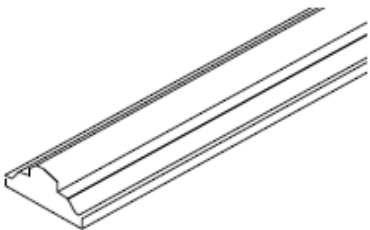
	Item Code	L x H	B2	H6	D3	K10	M01	A7	K8	J5
	FSM8	96 x 1.5	•	•	•	NA	NA	NA	NA	NA
	FSM10	120 x 1.5	NA	NA	NA	•	•	•	•	•

TURN POST

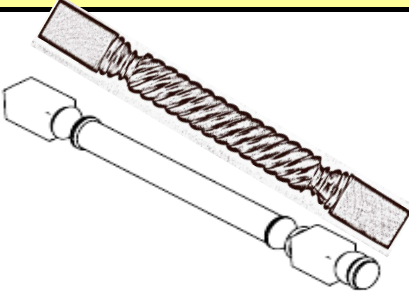
	Item Code	W" X D" X H"	B2	H6	D3	K10	M01	A7	K8	J5
	RP 34 1/2	3 x 3 x 34.5	NA	NA	NA	•	•	•	•	•
	SP3 * 34 1/2	3 x 3 x 34.5	•	•	•	•	•	•	•	•

FLUTED ROSETTE BLOCK

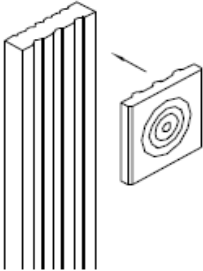
	Item Code	W" X D" X H"	B2	H6	D3	K10	M01	A7	K8	J5
	FB 3*3	3 x 1/2 x 3	•	•	•	•	•	•	•	•

FLUTED PLINTH BLOCK

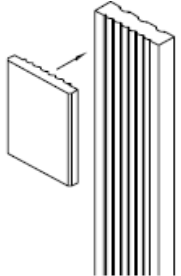
	Item Code	W" X D" X H"	B2	H6	D3	K10	M01	A7	K8	J5
	BB 3*3	3 x 1/2 x 4	•	•	•	•	•	•	•	•

FLUTED/BEADED FILLER

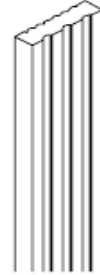
	Item Code	W" X D" X H"	B2	H6	D3	K10	M01	A7	K8	J5
	PCVFF3	3 x 3/4 x 96	•	•	•	•	•	•	•	•

TALL FILLER

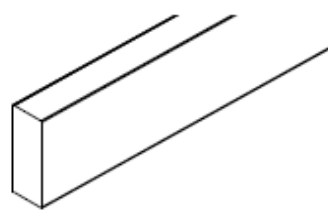
	Item Code	W" X D" X H"	B2	H6	D3	K10	M01	A7	K8	J5
	CM34-2	2 x 3/4 x 96	•	•	•	NA	NA	NA	NA	NA
	CM34-3	3 x 3/4 x 96	•	•	•	•	•	•	•	•

BASE FILLER

	Item Code	W" X D" X H"	B2	H6	D3	K10	M01	A7	K8	J5
	BF3	3 x 3/4 x 34.5	•	•	•	•	•	•	•	•
	BF6	6 x 3/4 x 34.5	•	•	•	•	•	•	•	•

WALL FILLER

	Item Code	W" X D" X H"	B2	H6	D3	K10	M01	A7	K8	J5
	WF330	3 x 3/4 x 30	•	•	•	•	•	•	•	•
	WF336	3 x 3/4 x 36	•	•	•	•	•	•	•	•
	WF342	3 x 3/4 x 42	•	•	•	•	•	•	•	•
	WF630	6 x 3/4 x 30	•	•	•	•	•	•	•	•
	WF636	6 x 3/4 x 36	•	•	•	•	•	•	•	•
	WF642	6 x 3/4 x 42	•	•	•	•	•	•	•	•
	WF1236	12 x 3/4 x 36	NA	NA	NA	•	•	•	•	•

DISHWASHER PANEL WITH 3" RETURN FILLER

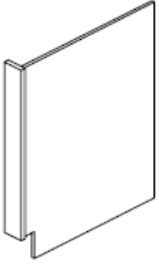
	Item Code	W" X D" X H"	B2	H6	D3	K10	M01	A7	K8	J5
	DWR	3 x 24 x 34.5	•	•	•	•	•	•	•	•
	*** WITH 3" RETURN (Can be used both Left & Right)									

REFRIGERATOR PANEL WITH 3" RETURN FILLER

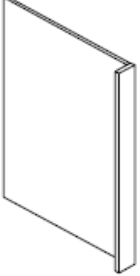
	Item Code	W" X D" X H"	B2	H6	D3	K10	M01	A7	K8	J5
	RRP8427		•	•	•	•	•	•	•	•
	RRP9027		•	•	•	•	•	•	•	•
	RRP9627		•	•	•	•	•	•	•	•
*** WITH 3" RETURN (Can be used both Left & Right)										

BASE SKIN PANEL

	Item Code	W" X D" X H"	B2	H6	D3	K10	M01	A7	K8	J5
	BP3696	96 x 1/8 x 36	•	•	•	•	•	•	•	•
	(SHORT GRAIN)									
	BP9636	36 x 1/8 x 96	•	•	•	•	•	•	•	•
	(LONG GRAIN)									

FRIEZE VALANCE

	Item Code	W" X D" X H"	B2	H6	D3	K10	M01	A7	K8	J5
	V30A	30 x 3/4 x 4	•	•	•	•	•	•	•	•
	V33A	33 x 3/4 x 4	NA	NA	NA	NA	NA	NA	NA	NA
	V36A	36 x 3/4 x 4	•	•	•	•	•	•	•	•
	V42A	42 x 3/4 x 4	•	•	•	•	•	•	•	•
	V48A	48 x 3/4 x 4				•	•	•	•	•
	V60A	60 x 3/4 x 4				•	•	•	•	•

ARCHED VALANCE

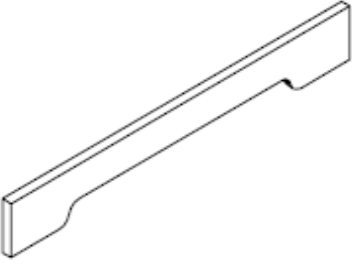
	Item Code	W" X D" X H"	B2	H6	D3	K10	M01	A7	K8	J5
	V30B	30 x 3/4 x 4	•	•	•	•	•	•	•	•
	V33B	33 x 3/4 x 4	NA	NA	NA	NA	NA	NA	NA	NA
	V36B	36 x 3/4 x 4	•	•	•	•	•	•	•	•
	V42B	42 x 3/4 x 4	•	•	•	•	•	•	•	•
	V48B	48 x 3/4 x 4	•	•	•	•	•	•	•	•
	V60B	60 x 3/4 x 4	•	•	•	•	•	•	•	•

ROLL OUT TRAY

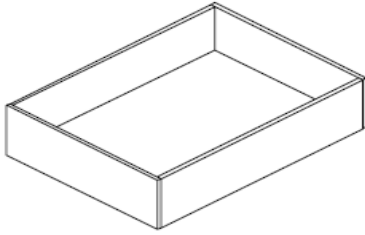

*Comes with Ball Bearing Glide

Item Code	W" X D" X H"	B2	H6	D3	K10	M01	A7	K8	J5
RD18		•	•	•	•	•	•	•	•
RD21		•	•	•	•	•	•	•	•
RD24		•	•	•	•	•	•	•	•
RD30		•	•	•	•	•	•	•	•
RD36		•	•	•	•	•	•	•	•

SPLIT POST



Item Code	W" X D" X H"	B2	H6	D3	K10	M01	A7	K8	J5
RPS18	2 x 3/4 x 18	•	NA	NA	•	•	•	•	•
RPS24	2 x 3/4 x 24	•	NA	NA	•	•	•	•	•
RPS30	2 x 3/4 x 30	•	NA	NA	•	•	•	•	•
RPS36	2 x 3/4 x 36	•	NA	NA	•	•	•	•	•
RPS42	2 x 3/4 x 42	•	NA	NA	•	•	•	•	•

SMALL GRAPE ORNAMENT

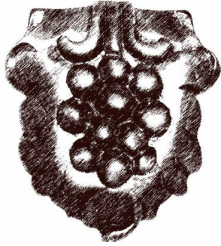

Item Code	W" X D" X H"	B2	H6	D3	K10	M01	A7	K8	J5
SGO	3 x 5/8 x 4	NA	NA	NA	•	•	•	•	•

SMALL LEAF ORNAMENT

Item Code	W" X D" X H"	B2	H6	D3	K10	M01	A7	K8	J5
RGO	3 x 5/8 x 4	NA	NA	NA	NA	NA	•		NA

SMALL GRAPE CORBEL

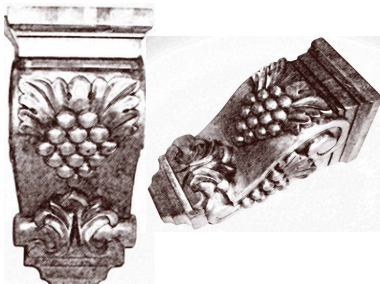

Item Code	W" X D" X H"	B2	H6	D3	K10	M01	A7	K8	J5
GC58	4 1/2 x 5 x 10	NA	NA	NA	•	•	•	NA	NA

SMALL LEAF CORBEL

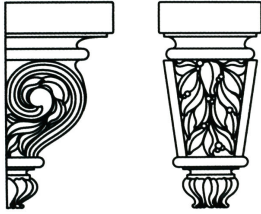

Item Code	W" X D" X H"	B2	H6	D3	K10	M01	A7	K8	J5
RC58	4 1/2 x 5 x 10	NA	NA	NA	•	NA	•	•	•

LARGE LEAF CORBEL



Item Code	W" X D" X H"	B2	H6	D3	K10	M01	A7	K8	J5
RC313	3 x 8 x 13	NA	NA	NA	•	•	•	•	•

GRAPE ONLAY

	Item Code	W" X D" X H"	B2	H6	D3	K10	M01	A7	K8	J5
		GRPO	20 x 5/8 x 4 1/2	•	NA	NA	•	•	•	NA

LEAF ONLAY

	Item Code	W" X D" X H"	B2	H6	D3	K10	M01	A7	K8	J5
		RRPO	20 x 5/8 x 4 1/2	•	NA	NA	•	NA	•	•

DÉCOR

	Item Code	W" X D" X H"	B2	H6	D3	K10	M01	A7	K8	J5
		ASO	6 x 5/8 x 6				•	•	NA	
	RSO	6 x 5/8 x 6				NA	NA	•		NA

TALL GRAPE ONLAY

	Item Code	W" X D" X H"	B2	H6	D3	K10	M01	A7	K8	J5
		OLC318	3 x 3 x 18	NA	NA	NA	•	•	•	•
	RLC318	3 x 3 x 18	NA	NA	NA	NA	NA	•	•	•

EX-LARGE CORBEL

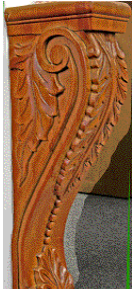
	Item Code	W" X D" X H"	B2	H6	D3	K10	M01	A7	K8	J5
		CB34 1/2	6 1/4 x 5 1/4 x 34 1/2	NA	NA	NA	•	NA	•	•
	RC530									

RC530

VANITY CABINETS

SINK VANITY- CURVE DOOR FRONT- 2 DOOR

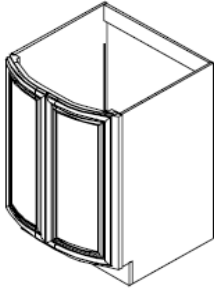

Item Code	W" X D" X H"	C2	C6	C3	K10	M01	A7	K8	J5
SVA24	24 x 24 x 33	•	•	•	•	•	•	•	•

*** ADDITIONAL DECORATIVE FOOT LEGS (*24 / * 30) AVAILABLE**

SINK VANITY- STRAIGHT DOOR- 2 DOOR (FLAT FRONT)

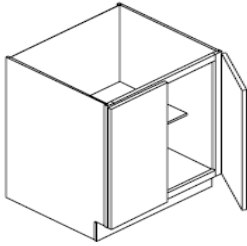

Item Code	W" X D" X H"	C2	C6	C3	K10	M01	A7	K8	J5
SVA24P	24 x 21 x 33	•	•	•	•	•	•	•	•

VANITY DRAWER BASE- 3 DRAWER

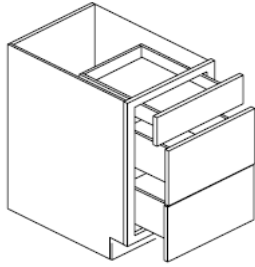

Item Code	W" X D" X H"	C2	C6	C3	K10	M01	A7	K8	J5
SVA09D	09 x 21 x 33				SPC	SPON	NA		
SVA12D	12 x 21 x 33	•	•	•	•	•	•	•	•
SVA15D	15 x 21 x 33	•	•	•	•	•	•	•	•
SVA18D	18 x 21 x 33	•	•	•	•	•	•	•	•
SVA24D	24 x 21 x 33	•	•	•	•	•	•	•	•

VANITY BASE CABINET- 1 DRAWER 1 DOOR

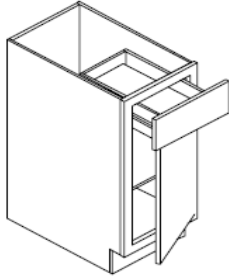

Item Code	W" X D" X H"	C2	C6	C3	K10	M01	A7	K8	J5
SVA09P	09 x 21 x 33	•	•	•	•	•	•	•	•
SVA12P	12 x 21 x 33	•	•	•	•	•	NANA	NA	NA
SVA15P	15 x 21 x 33	•	•	•	•	•	NANA	NA	NA
SVA18P	18 x 21 x 33	•	•	•	•	•	NANA	NA	NA

VANITY BASE CABINET- 1 DUMMY DRAWER 2 DOOR

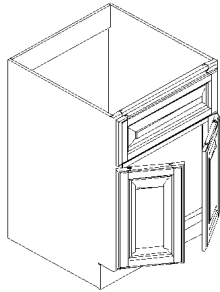

Item Code	W" X D" X H"	C2	C6	C3	K10	M01	A7	K8	J5
FA3021	30 x 21 x 33	•	•	•	•	•	•	•	•

VANITY BASE CABINET- LEFT DOOR - 1 DOOR, 2 DRAWER, 1 DUMMY DRAWER

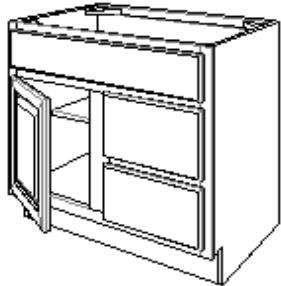

Item Code	W" X D" X H"	C2	C6	C3	K10	M01	A7	K8	J5
FA3021DL	30 x 21 x 33	•	•	•	•	•	•	•	•

VANITY BASE CABINET- RIGHT DOOR - 1 DOOR, 2 DRAWER, 1 DUMMY DRAWER

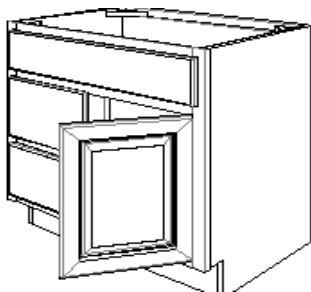

Item Code	W" X D" X H"	C2	C6	C3	K10	M01	A7	K8	J5
FA3021DR	30 x 21 x 33	•	•	•	•	•	•	•	•

VANITY BASE CABINET- 2 DOOR, 2 DRAWER, 1 DUMMY DRAWER

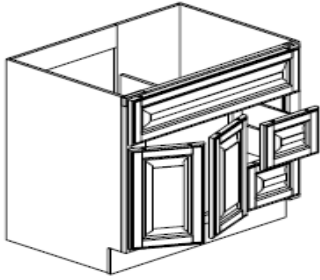

Item Code	W" X D" X H"	C2	C6	C3	K10	M01	A7	K8	J5
FA3621DL	36 x 21 x 33	•	•	•	•	•	•	•	•

VANITY BASE CABINET- 2 DOOR, 2 DRAWER, 1 DUMMY DRAWER

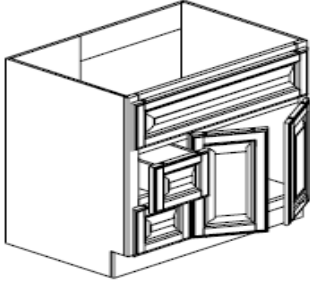

Item Code	W" X D" X H"	C2	C6	C3	K10	M01	A7	K8	J5
FA3621DR	36 x 21 x 33	•	•	•	•	•	•	•	•

VANITY BASE CABINET- 2 DOOR, 6 DRAWER, 1 DUMMY DRAWER

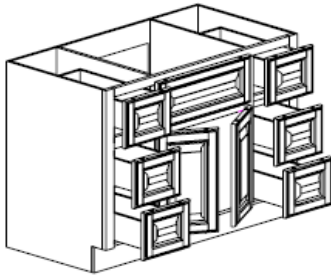

Item Code	W" X D" X H"	C2	C6	C3	K10	M01	A7	K8	J5
FA4821D	48 x 21 x 33	•	•	•	•	•	•	•	•
FA6021D	60 x 21 x 33	•	•	•	•	•	•	•	•

VANITY BASE CABINET- 2 DOOR, 3 DRAWER, 2 DUMMY DRAWER

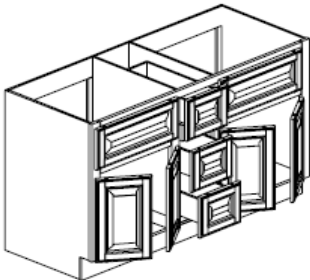

Item Code	W" X D" X H"	C2	C6	C3	K10	M01	A7	K8	J5
FA6021DD	60 x 21 x 33	•	•	•	•	•	•	•	•

VANITY PANTRY- 2 DOOR, 4 SHELF

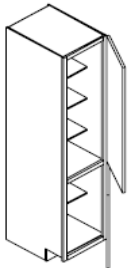

Item Code	W" X D" X H"	C2	C6	C3	K10	M01	A7	K8	J5
SVA188124P	18 x 24 x 81	•	•	•	•	•	•	•	•

VANITY MIRROR

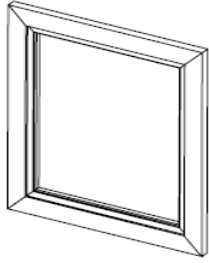

Item Code	W" X D" X H"	C2	C6	C3	K10	M01	A7	K8	J5
SVAM2427	24 x 1 x 27	•	•	•	•	•	•	•	•
SVAM3027	30 x 1 x 27	•	•	•	•	•	•	•	•
SVAM3036	30 x 1 x 36	NA	NA	NA	NA	NA	NA	NA	NA

MEDICINE CABINET- 1 DOOR 2 SHELF

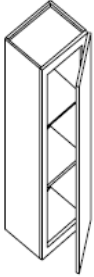

Item Code	W" X D" X H"	C2	C6	C3	K10	M01	A7	K8	J5
WV12336	12 x 6 x 33	•	•	•	•	•	•	•	•

CURVED BALL FOOT LEG

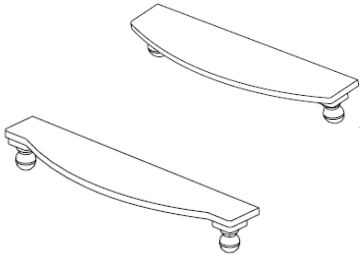

Item Code	W" X D" X H"	C2	C6	C3	K10	M01	A7	K8	J5
*24	24 x 7 x 4 1/2	•	•	•	•	•	•	•	•
*30	30 x 7 x 4 1/2	•	•	•	•	•	•	•	•

***TO BE USE WITH SVA24

VANITY COUNTER CABINET- 2 DRAWER 1 DOOR

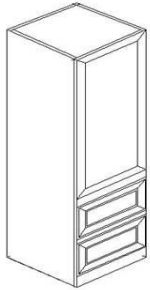

Item Code	W" X D" X H"	C2	C6	C3	K10	M01	A7	K8	J5
DV121245.5	12 x 12 x 45.5				•	•	•	•	•